

7 SERIES LED LUMINAIRE

Zones 1, 2, 21, 22

Full catalogue available on our website: www.inpratex.com

LED LIGHT FITTINGS

ZONES 1, 2 (gas) & 21, 22 (dust)

High efficiency Zone 1 and Zone 21 LED Luminaire for use in hazardous areas. Manufactured from impact resistant polycarbonate and high specification marine grade aluminium, the fitting is supplied anodised and painted.



Low maintenance high efficiency LED light source.

Energy efficient control.

2 different versions.

Robust long life Zone 1 enclosure.



EU-Type Examination Certificate

ITEM REFERENCES

Designation:	Power:	Size:	Luminous flux:	Item No.:
15W Ex d Zone 1 Luminaire	15 W	1 - 448 mm	1335 lm	1A4701
30W Ex d Zone 1 Luminaire	30 W	2 - 752 mm	2670 lm	1A4702

TECHNICAL SPECIFICATIONS

Marking:	II 2G Ex db op is IIC T6 Gb II 2D Ex tb op is IIIC T85°C Db
Certificate:	EU-Type Examination Certificate
Operating temperature:	-20°C to +55°C
Housing:	Marine grade aluminium body with high impact polycarbonate tube
Ingress protection:	IP66
Light output:	High efficiency LED with various outputs
Supply voltage:	230V 50/60Hz.
Control gear:	Electronic drive
Electrical connections:	3 wire and earth cable size 4mm ² max. Through wiring as standard
Installation / Mounting:	2 x M8 tapped holes. Size 1: 335 mm, size 2: 632 mm
Cable entries:	4 x M20 (3 plugged)

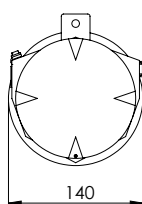
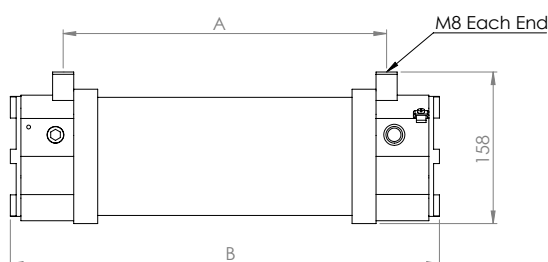

DIMENSIONS

SIZE	A:	B:	Weight:
1	335 mm	448 mm	3 kg
2	632 mm	752 mm	5 kg